

# CareStart™ COVID-19 ANTIGEN

Rapid Diagnostic Test for the Detection  
of SARS-CoV-2 Antigen



The **CareStart™** COVID-19 Antigen Test is a lateral flow immunochromatographic assay intended for the qualitative detection of SARS-CoV-2 nucleocapsid protein in nasopharyngeal swab specimens collected directly from people who are possibly infected with COVID-19.

✓ Fast and easy to use

✓ Use for nasopharyngeal (NP) swab specimen



First Aid  
Supplies®

[www.firstaidsupplies.org](http://www.firstaidsupplies.org)

# Test Procedures

## Nasopharyngeal (NP) Swab Collection

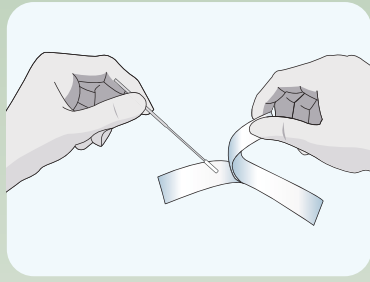

1 Remove a swab from the pouch.

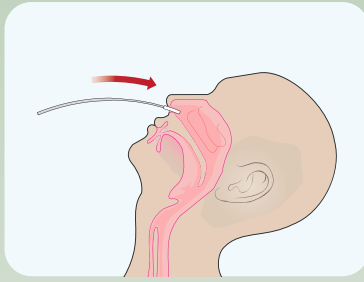

2 Place the swab into one of patient's nostrils until it reaches the posterior nasopharynx.

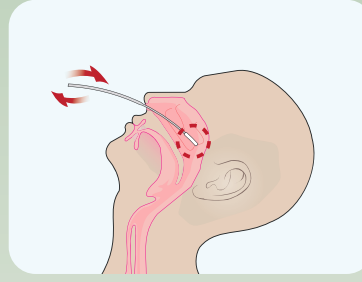

3 Slowly rotate 5 times the swab over the surface of the posterior nasopharynx.

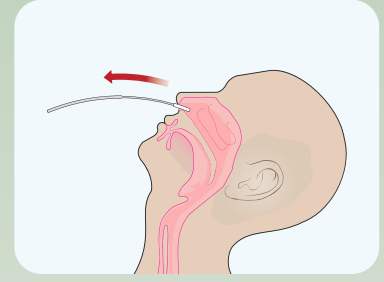

4 Remove the swab from the nostril.



5 Peel off aluminum foil seal.

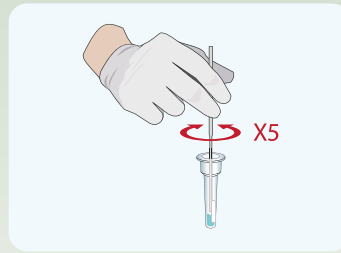

6 Place the swab into the extraction vial. Rotate the swab vigorously at least 5 times.

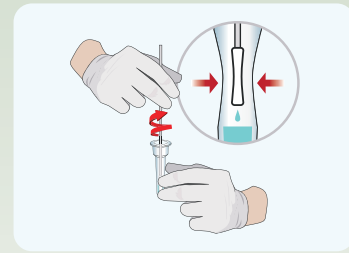

7 Remove the swab by rotating against the extraction vial while squeezing the sides of the vial to release the liquid from the swab. Properly discard the swab.

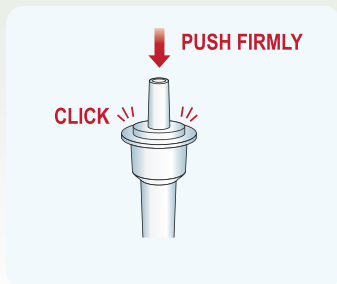

8 Close the vial by pushing the cap firmly onto the vial.

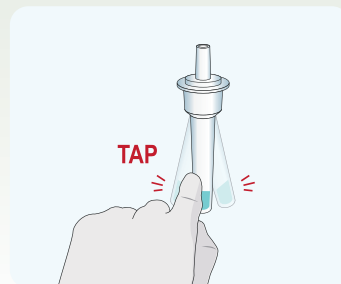

9 Mix thoroughly by flicking the bottom of the tube.

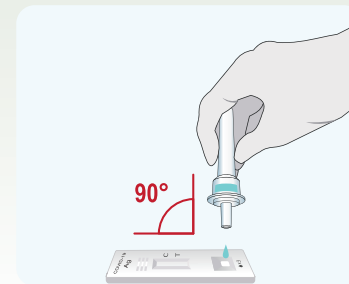

10 Invert the extraction vial and hold the sample vertically above the sample well. Squeeze the vial gently. Allow three (3) drops of sample to fall into the sample well.

Start the timer



Read the result at 10 minutes. The test result should not be read after 15 minutes.



### Result Interpretation

SARS-CoV-2 Positive

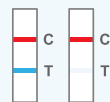

Negative



Invalid



#### NOTES

- The color intensity in the test region will vary depending on the amount of SARS-CoV-2 antigen present in the sample.  
- Any faint colored line(s) in the test region(s) should be considered as positive.

#### NOTES

- Re-run the test one time using the remaining specimen in the extraction vial.

### Order Information

Product Code	410089
Package Unit	20 tests/kit
Kit Component	20 Test devices 20 Extraction vial/cap 1 Positive control swab 1 Negative control swab 1 Package insert 1 QRI



First Aid  
Supplies®

FREE CALL 1800 347782 | [sales@firstaidsupplies.org](mailto:sales@firstaidsupplies.org)

Address: Unit 7 BEAT, Stephenstown Industrial Estate, Balbriggan, Co. Dublin