

UG800

Smart Home Gateway

About this product...

The SALUS UG800 Smart Home Gateway is the central hub of the SALUS Smart Home system, enabling up to 100 smart devices to seamlessly communicate and interact with each other. This gateway creates a unified, intelligent ecosystem where devices like thermostats, smart plugs, and relays work together to optimize comfort, energy efficiency, and convenience. The UG800 makes it easy to set up and manage your smart home network, ensuring that all connected devices operate in harmony. Whether you're controlling your heating, lighting, or security systems, the gateway provides the necessary infrastructure to keep everything running smoothly.

Designed with user convenience in mind, the SALUS UG800 is both compact and discreet, easily fitting into any home environment without drawing attention. Despite its small size, it boasts impressive capabilities, including an Ethernet connection speed of up to 100 Mbps, ensuring a stable and reliable internet connection for your smart home devices. This high-speed connectivity helps maintain real-time communication between devices, allowing for instant response and control via the SALUS Smart Home app.



At the heart of the SALUS Smart Home Range



Features

- Simple & Quick setup from Smart Home App
- Connects up to 100 devices
- Full Zigbee 3.0 compliance
- 10/100Mbps Ethernet connection for stable internet connection
- Supports cloud integration to AWS IoT

Specification

Connectivity	ZigBee 3.0 Compliance
Input Power	5 VDC from micro USB port
Wired Communication	10/100Mbps Ethernet
Wireless Communication	Bluetooth V4.2 BR/EDR & BLE (For commissioning only) Zigbee WiFi: 802
Operating Temperature	0 to 40°C
Guarantee	5 Years

Dimensions

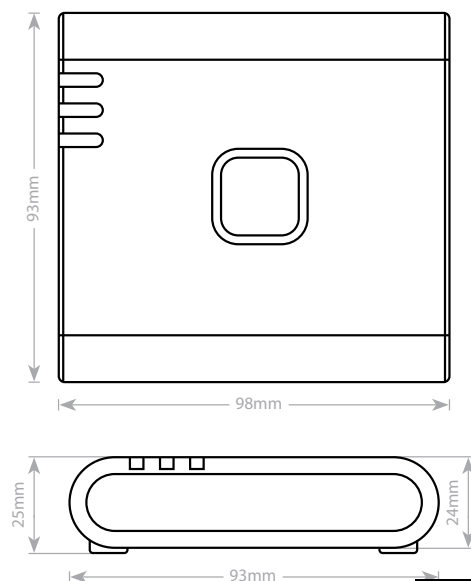

UG800 Smart Home Gateway - Technical Data

Electrical and Mechanical Specifications

Input voltage	5 VDC from micro USB port
Connectivity	ZigBee 3.0 Compliance
Wired Communication	10/100Mbps Ethernet for stable internet connection
Wireless Communication	Bluetooth V4.2 BR/EDR & BLE (For commissioning only) Zigbee WiFi: 802
Mounting	Desktop or surface mount with additional wall bracket (purchased seperately)
Connectivity	Connects up to 100 end devices
WiFi Connection	802.11 b/g/n
Firmware update	Over the air firmware update capability
Transmission Power	WiFi: Maximum 20dBm ZigBee: Maximum 10dBm (EU), 18dBm (NA)
Communication	Mobile App operation
Outdoor Transmission range	Bluetooth: Mini 10m WiFi: Mini. 60m Zigbee: Mini. 200m
Power Consumption	Max. 3W
Operating Environment:	Indoor, residential.
Storage temperature	-10°C – 60°C
Operating temperature	0°C – 40°C
Dimensions (H x W x D)	98mm x 93mm x 25mm
Relative humidity (noncondensed)	5%--95% RH
Ingress Protection Rating	IP30
Regulation	CE, R&TTE, UKCA for EU
Environmental Requirement	RoHS compliance, Arsenic Free, PVC Free , REACH/WEEE directive
Guarantee	5 Years

Control & Monitor from anywhere...

With the SALUS Premium Lite App.
Download it from Google Play or the App Store.



Easy to install and operate ...

The SALUS UG800 Smart Home Gateway is the essential central hub of the SALUS Smart Home system, facilitating seamless communication and interaction between up to 100 smart devices. This gateway creates a unified smart home environment, where devices such as thermostats, smart plugs, and relays work together to enhance comfort and efficiency. Its user-friendly design makes installation and setup straightforward, allowing homeowners to quickly integrate it into their existing home network. Additionally, the UG800 offers flexible placement options, as it can be either desktop-mounted or wall-mounted with the optional wall plate (sold separately), ensuring it fits perfectly within any smart home setup.



Control via the App...

Easily control and monitor from your phone.

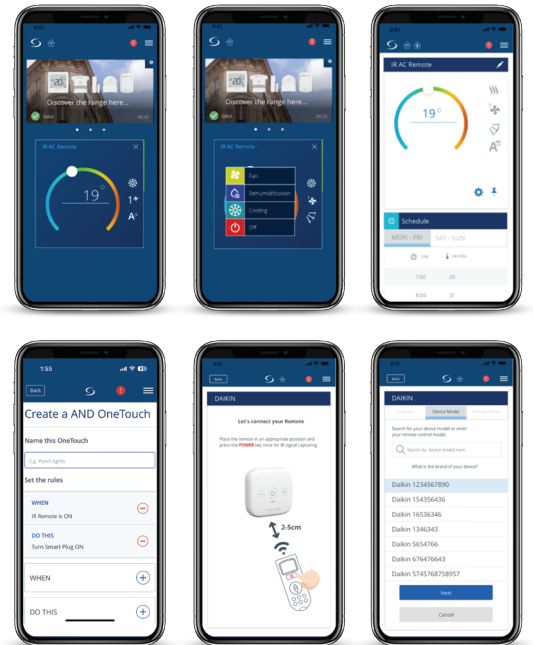

Scan QR Code to View Product on Website

Visit **Plumb2u**

Tel: 01226 323961

email: sales@saluscontrols.com/gb

saluscontrols.com See product